

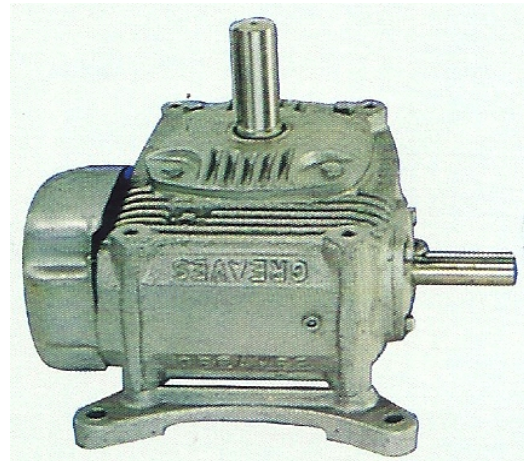

**PREMIUM**

**GREAVES**

**ADAPTABLE WORM GEARBOXES**

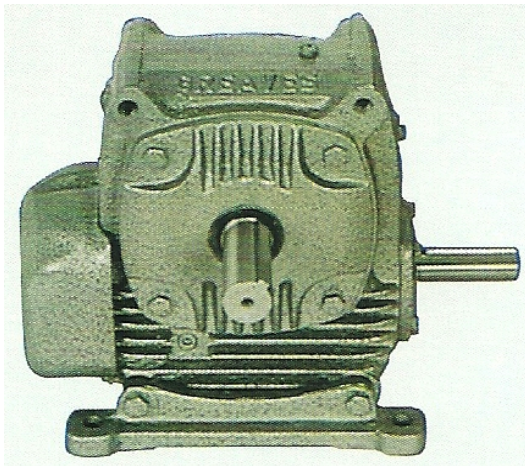

*Authorised Distributors*



**SC Industrial Syndicate**

5/105, Bombay Samachar Marg, Fort, Mumbai 400 023

Tel : 022 2266 3444 / 5615 / 5439 / 1840 / 1079 Fax : 2266 0628

Website : [www.scindustrial.com](http://www.scindustrial.com) Email : [sales@scindustrial.com](mailto:sales@scindustrial.com)

# SC Industrial Syndicate



**PREMIUM**

## Ratings at 1500 RPM Input Speed

Nominal Ratio RPM	Nominal Output	Capacity	Unit Size					
			112	162	200	237	287	337
5/1	300	Input Power KW	0.548	1.243	2.72	4.05	5.51	10.8
		Output Torque Nm	16.6	38.4	77.5	121	171	312
7.5/1	200	Input Power KW	-	1.081	1.93	2.92	4.76	7.24
		Output Torque Nm	-	45.8	82.6	126	203	311
10/1	150	Input Power KW	0.432	1.052	1.88	2.60	3.82	6.29
		Output Torque Nm	24.6	61.8	112	146	228	354
15/1	100	Input Power KW	0.329	0.942	1.50	2.30	3.71	5.62
		Output Torque Nm	25.0	73.5	120	186	301	462
20/1	75	Input Power KW	0.300	0.655	1.40	2.30	3.71	5.62
		Output Torque Nm	28.3	67.1	142	233	294	447
25/1	60	Input Power KW	0.266	0.578	1.14	1.83	2.74	3.91
		Output Torque Nm	30.2	70.8	142	231	352	511
30/1	50	Input Power KW	0.217	0.515	0.94	1.46	2.31	3.50
		Output Torque Nm	28.5	73.0	137	214	348	537
40/1	37.5	Input Power KW	0.164	0.427	0.70	1.06	1.68	2.55
		Output Torque Nm	25.4	76.1	129	197	321	498
50/1	30	Input Power KW	0.112	0.309	0.53	0.820	1.31	1.91
		Output Torque Nm	20.9	65.0	115	180	301	446
60/1	25	Input Power KW	0.096	0.240	0.38	0.60	1.00	1.55
		Output Torque Nm	14.8	43.5	75.2	121	264	412
70/1	21.4	Input Power KW	0.090	0.206	0.35	0.53	1.81	1.18
		Output Torque Nm	14.6	43.7	74.0	118	198	305

Nominal Ratio RPM	Nominal Output	Capacity	Unit Size				
			400	500	600	700	800
5/1	300	Input Power KW	12.8	20.9	38.4	51.5	70.4
		Output Torque Nm	372	629	1130	1560	2140
7.5/1	200	Input Power KW	9.18	17.5	26.3	41.5	54.4
		Output Torque Nm	405	769	1190	1860	2450
10/1	150	Input Power KW	8.36	15.9	23.1	31.9	41.3
		Output Torque Nm	467	914	1330	1840	2390
12.5/1	120	Input Power KW	7.25	-	-	-	-
		Output Torque Nm	530	-	-	-	-
15/1	100	Input Power KW	6.67	11.3	20.0	27.6	37.1
		Output Torque Nm	541	927	1700	2360	3190
20/1	75	Input Power KW	5.81	10.4	15.9	21.5	29.4
		Output Torque Nm	618	1130	1800	2370	3280
25/1	60	Input Power KW	4.76	8.00	12.5	19.7	26.9
		Output Torque Nm	616	1060	1680	2680	3710
30/1	50	Input Power KW	4.25	7.45	11.8	16.2	21.6
		Output Torque Nm	641	1160	1880	2610	3500
35/1	42.9	Input Power KW	-	6.71	10.3	14.2	-
		Output Torque Nm	-	1190	1880	2580	-
40/1	37.5	Input Power KW	3.50	5.72	9.64	13.7	17.9
		Output Torque Nm	673	1110	1960	2830	3740
50/1	30	Input Power KW	2.68	4.74	7.81	11.9	15.7
		Output Torque Nm	603	1110	1900	2980	3950
60/1	25	Input Power KW	2.29	4.16	6.24	9.4	13.2
		Output Torque Nm	593	1140	1750	2720	3870
70/1	21.4	Input Power KW	1.98	3.40	5.35	7.75	10.9
		Output Torque Nm	577	1030	1670	2490	3540



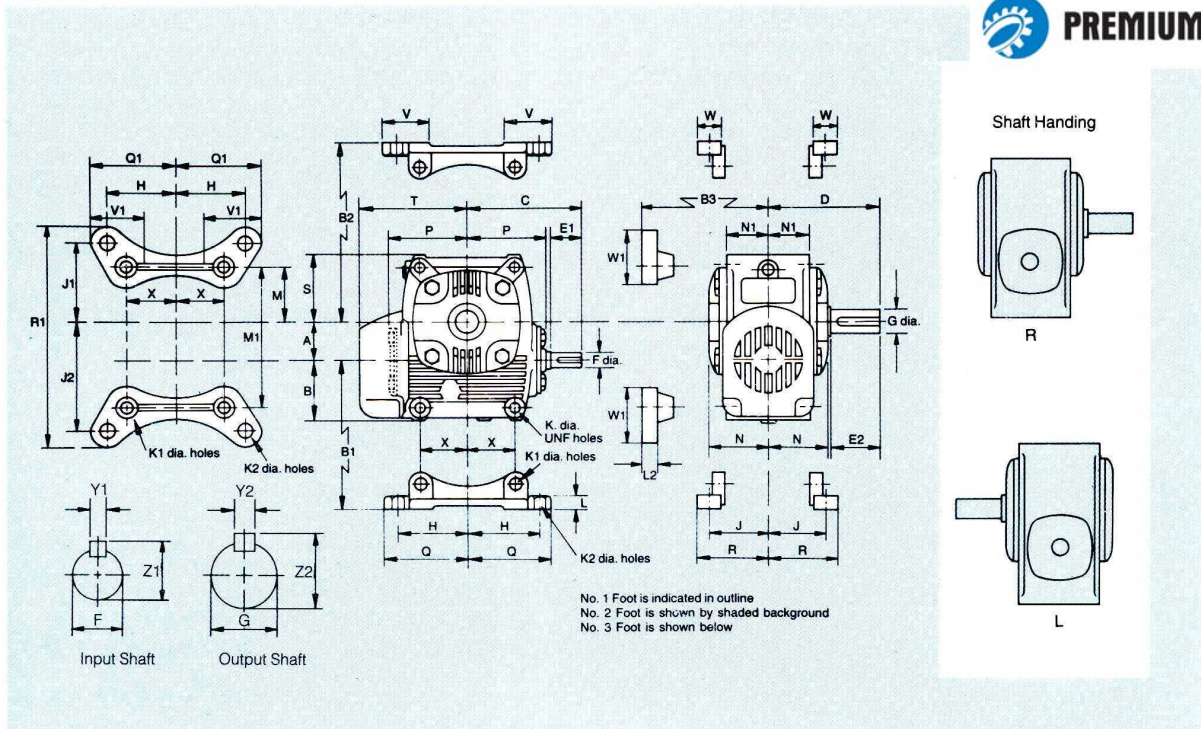

## Adaptable Speed Reducers

Principal Dimensions (mm)

SIZE	A	B	C	D	E1	E2	E3	E4	F	G	K	M	M1	N	N1	P	S	T	X	Y1	Y2	Z1	Z2
112	28.6	44.5	90	79	29	35	25.4	32	11.113	15.875	6.4	41.3	104.8	41	30	62	51	81	34.9	3.226	4.826	12.50	17.98
									11.102	15.865										3.175	4.775	12.29	17.78
162	41.3	50.8	110	98	41	48	38	44	15.875	19.050	6.4	47.6	130.2	49	37	71	57	89	39.7	4.826	4.826	17.98	21.16
									15.865	19.037										4.775	4.775	17.78	20.96
200	50.8	58.7	133	117	48	57	44	54	15.875	25.400	7.9	60.3	158.8	59	43	86	71	111	50.8	4.826	6.401	17.98	28.19
									15.865	25.387										4.775	6.350	17.78	27.99
237	60.3	68.3	159	140	57	70	54	67	19.050	28.575	9.5	71.4	187.3	68	51	98	84	130	60.3	4.826	7.976	21.16	32.05
									19.037	28.562										4.775	7.925	20.96	31.85
287	73.0	77.8	191	168	70	83	67	79	22.225	31.750	11.1	88.9	225.4	81	64	119	103	154	76.2	6.401	7.976	25.02	35.23
									22.212	31.735										6.350	7.925	24.82	35.03
337	85.7	90.6	219	200	83	98	79	95	25.400	38.100	12.7	100.0	260.4	98	76	133	116	175	85.7	6.401	9.576	28.19	42.27
									25.387	38.085										6.350	9.525	27.99	42.06

Shaft tolerances are to B.S. 1916 : 1962, h6, Keyways are to B.S. 46 : 1958

No. 1 Foot													
SIZE	B1	B2	H	J	K1	K2	L	N1	Q	R	V	W	X
112	52.4	58.7	52.4	41.3	7.1	8.7	13	30	62	51	35	19	34.9
162	60.3	66.7	58.7	49.2	7.1	10.3	14	37	70	60	38	22	39.7
200	69.9	82.6	76.2	57.2	8.7	10.3	14	43	91	73	49	29	50.8
237	84.1	100.0	87.3	68.3	10.3	11.9	17	51	103	84	54	32	60.3
287	95.3	120.7	106.4	82.6	11.9	13.5	21	64	124	100	60	35	76.2
337	109.5	134.9	119.1	96.8	13.5	15.1	22	76	138	116	67	38	85.7

No. 2 Foot														
SIZE	B3	H	J1	J2	K1	K2	L	M	M1	Q1	R1	V1	W1	X
112	54.0	52.4	57.2	79.4	7.1	8.7	13	41.3	104.8	64	159	37	41	34.9
162	63.5	58.7	65.1	100.0	7.1	10.3	14	47.6	130.2	71	191	40	46	39.7
200	69.9	76.2	82.6	120.7	8.7	10.3	14	60.3	158.8	89	229	51	52	50.8
237	82.6	87.3	95.3	139.7	10.3	11.9	17	71.4	187.3	103	267	57	59	60.3
287	98.4	106.4	114.3	161.9	11.9	13.5	21	88.9	225.4	124	311	65	65	76.2
337	114.3	119.1	128.6	188.9	13.5	15.1	22	100.0	260.4	138	356	73	73	85.7

No. 3 Foot								
SIZE	B4	J3	L	M1	Q2	R2	V	W2
112	93.7	55.6	10	104.8	124	65	35	29
162	101.6	65.1	11	130.2	152	76	38	32
200	127.0	71.4	14	158.8	191	89	49	38
237	146.1	84.1	17	187.3	219	100	54	41
287	173.0	101.6	19	225.4	260	119	60	48
337	193.7	115.9	21	260.4	298	133	67	49

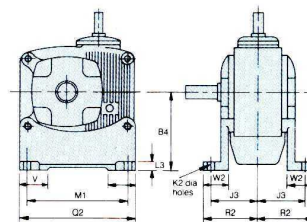

As improvements in design are continually being made, this specification is not to be regarded as binding in detail, and dimensions are subject to alteration without notice.



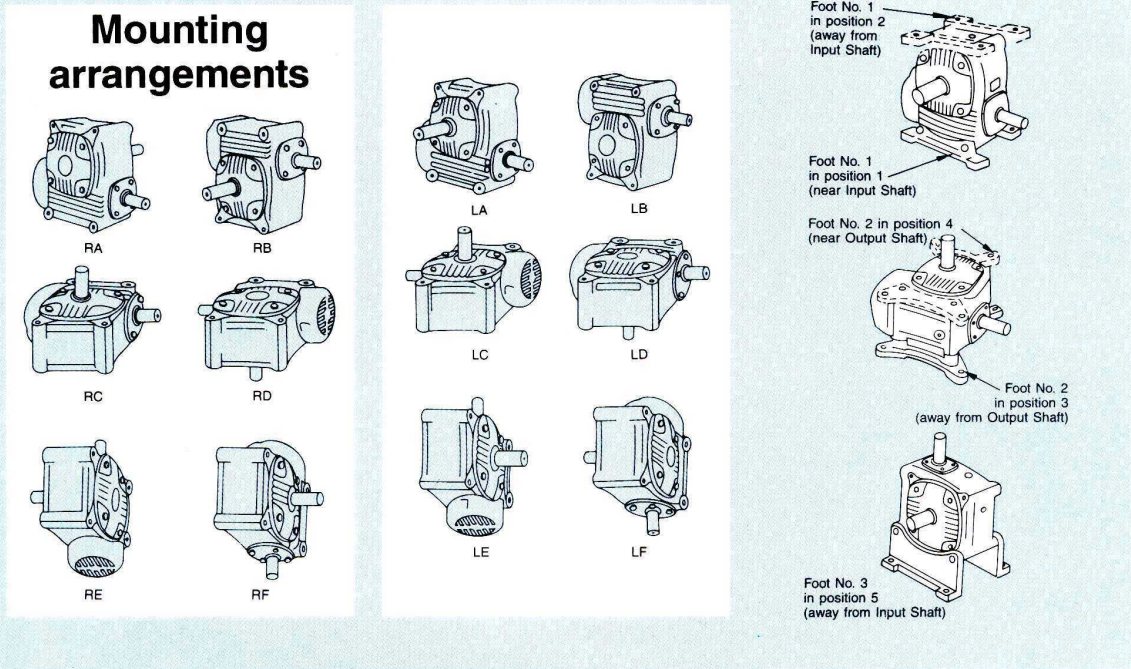

## Handing and Mounting

Adaptable Greaves Speed Reducers can be mounted in an almost unlimited number of different positions. The diagrams above indicate typical commonly used "space" dispositions of Adaptables showing the numerous shaft arrangements. The three types of feet, as shown on page 2, can be used in all these positions.

The two basic unit positions are shown under the headings "right handing - R" and "left handing - L" where the unit is arranged in the upright position, with shafts in the horizontal plane and the high speed shaft located under the slow speed shaft.

A right hand unit is one where, when looking on the end of the high speed shaft, the slow speed shaft extensions is to the right. Similarly, a left hand unit has the slow speed shaft extensions to the left.

Oil level, breather and drain plugs are arranged to suit these basic positions. Where units are mounted in other positions it is necessary to change the positions of the breather. **The diagrams on page 6 show plug positions for the different mounting arrangements.**

## Enquiries

It is recommended that as much as possible of the following information be given on enquiry or order so that a check can be made, and advice given on the most suitable size of Greaves for any particular application.

1. Quantity
2. Prime mover
3. Horse-power of prime mover
4. Output torque required from driven member
5. Input speed of gear unit
6. Output speed of gear unit
7. Application of drive

### Typical Catalogue Number

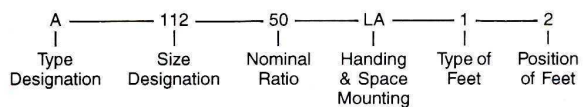

Full details from the nameplate should be specified for spare parts.

## Oil capacity and shipping specification

	Size of unit					
	112	162	200	237	287	337
Net Weight (kg.)	5	7	13	20	31	49
Gross Weight (kg.)	5	8	14	21	34	50
Volume Packed (cu.m.)	0.004	0.007	0.013	0.022	0.034	0.048
Oil Required at 1st filling (lit.)	0.14	0.28	0.28	0.57	0.85	1.42

A supply of oil is not included in any unit